

East Coast Sensors

Aluminum bracket RTD Series RC5

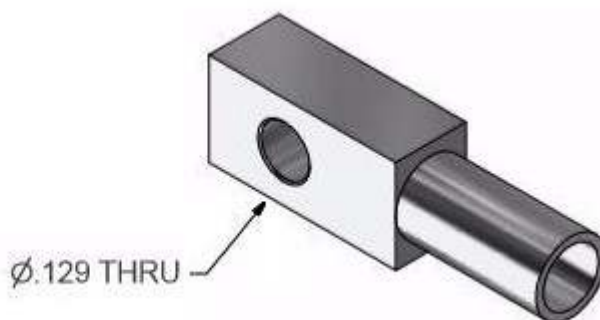
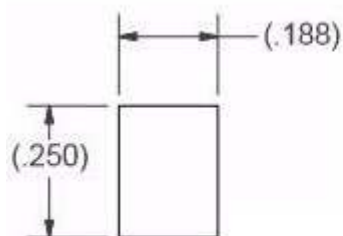

Ordering Information Part Number

① RC5	② Element type	③ Element	④ Wire Configuration	⑤ Bracket Type	⑥ Lead wire material	⑦ Lead wire Length (In.)	⑧ Termination Style	⑨ Special Features
RC5								

Optional

②	Element type
T	100 Ω DIN 00385 (thin film)
U	500 Ω DIN 00385 (thin film)
W	1000 Ω DIN 00385 (thin film)
X	120 Ω Nickel DIN 00672 (thin film)
Y	100 Ω DIN 003916 (wire wound)
Z	500 Ω DIN 003916 (wire wound)
Q	10 Ω copper (thin film)

③	Element Accuracy (0 °C)
A	Class A (0.06%)
B	Class B (0.12%)

④	Wire Configuration
2	2-wire
3	3-wire
4	4-wire

⑤	Bracket type
W	Straight aluminum mounting bracket (1/2" long w/ 1/8" hole)

⑥	Lead wire material
A	Fiberglass (800°F)
B	Fluoropolymer (400°F)
C	Fiberglass with stainless steel braid (800°F)
D	Fluoropolymer with stainless steel braid (400°F)

⑦	Lead wire length
006-999"	Specify in Inches
	Over 999" contact factory

⑧	Termination style
A	2" stripped leads (bare ends) (standard)
B	2" stripped leads w/ #8 spade lugs
C	Standard male 2 pin plug (400°F)
D	Standard male 3 pin plug (400°F)
F	Standard 2 pin female jack (400°F)
G	Standard 3 pin female jack (400°F)
H	Miniature male 2 pin plug (400°F)
P	Miniature male 3 pin plug (400°F)
J	Miniature female 2 pin jack (400°F)
K	Miniature female 3 pin jack (400°F)
W	2" stripped leads w/ pin terminals
Q	2" stripped leads w/ wire ferrules
X	Extra long lead wire length (beyond 2" stripped leads) (specify extra long lead wire length below)
006"-240"	006"-240" Specify in Inches

Optional

⑨	Special features
Note	Leave blank for no special features
07	Cable clamp
09	Mating connector

